

FIXED SLOT DIFFUSER
TE600 • TE700

Installation dimensions

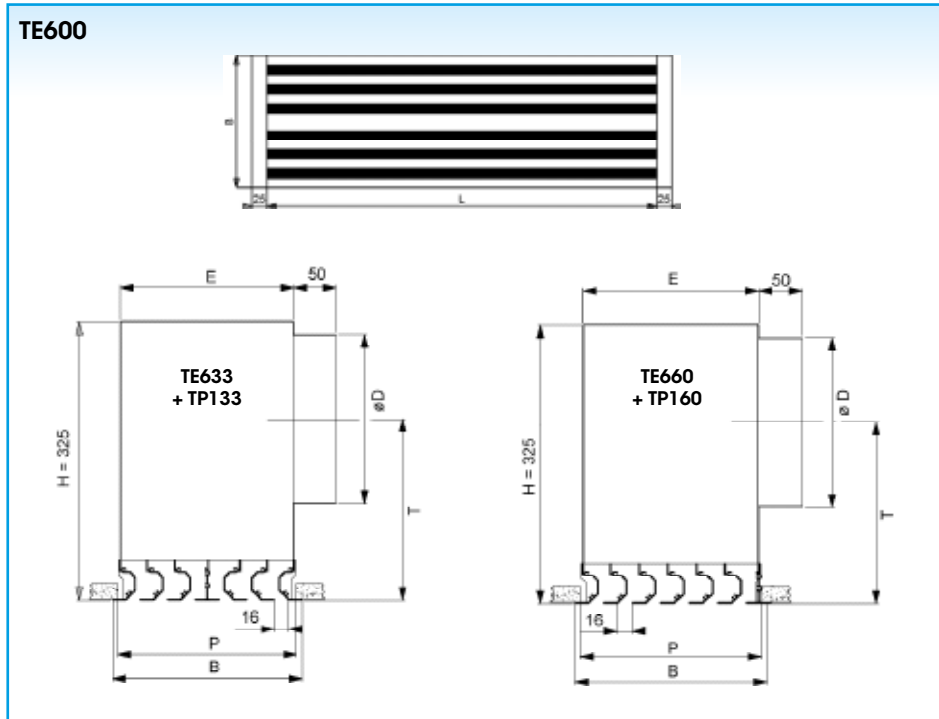

	1 SLOT				2 SLOTS			
L	300	600	900	1200	300	600	900	1200
B	61	61	61	61	93	93	93	93
Ø D	125	125	160	200	125	160	200	250
T	250	250	232	212	250	232	212	187
E (1R)	36	36	36	36	68	68	68	68
E (2R)	-	-	-	-	73	73	73	73
P	48	48	48	48	80	80	80	80
	3 SLOTS				4 SLOTS			
L	300	600	900	1200	300	600	900	1200
B	125	125	125	125	157	157	157	157
Ø D	160	200	250	250	200	250	250	250
T	232	212	187	187	212	187	187	187
E (1R)	100	100	100	100	132	132	132	132
E (2R)	105	105	105	105	137	137	137	137
P	112	112	112	112	144	144	144	144
	5 SLOTS				6 SLOTS			
L	300	600	900	1200	300	600	900	1200
B	189	189	189	189	221	221	221	221
Ø D	200	250	250	250	200	250	250	250
T	212	187	187	187	212	187	187	187
E (1R)	164	164	164	164	196	196	196	196
E (2R)	169	169	169	169	201	201	201	201
P	176	176	176	176	208	208	208	208
	7 SLOTS				8 SLOTS			
L	300	600	900	1200	300	600	900	1200
B	253	253	253	253	285	285	285	285
Ø D	200	250	250	250	200	250	250	250
T	212	187	187	187	212	187	187	187
E (1R)	228	228	228	228	260	260	260	260
E (2R)	233	233	233	233	265	265	265	265
P	240	240	240	240	272	272	272	272

L = nominal length
All dimensions in mm

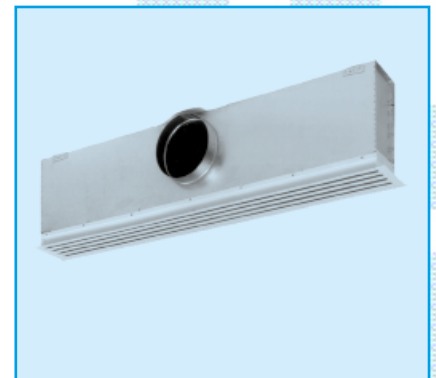

Application

The slot diffuser, type TE600/700, is used for the supply and exhaust of cooled and heated air in facilities such as offices, meeting rooms, shops, ...

The especially developed deflectors ensure a stable horizontal air supply pattern and a low noise level. The result is a high induction level and an air flow penetration in the space without internal turbulences. By the reduced pressure drop, the diffuser is the ideal solution for VAV-applications.

Technical information

Characteristics

- choice of the supply direction of the fixed not adjustable deflectors in 1 or 2 directions (supply directions provided right air entry)
- diffuser supplied with plenum, optional internal insulation, with or without damper; the plenum is fixed directly on the diffuser (mounting by Grada upon re-quest)
- **TE600**: fixed core, available with 1-8 slots, standard lengths 300, 600, 900, 1200 mm
- **TE700**: hinged core, with push-pull closing (available from 4 slots)

Construction

- aluminium diffuser, painted white (RAL 9010)
- galvanised steel sheet plenum
- plenum provided with mounting eyes (Ø 7 mm), mounting straps available upon request

TE733 + TP 733

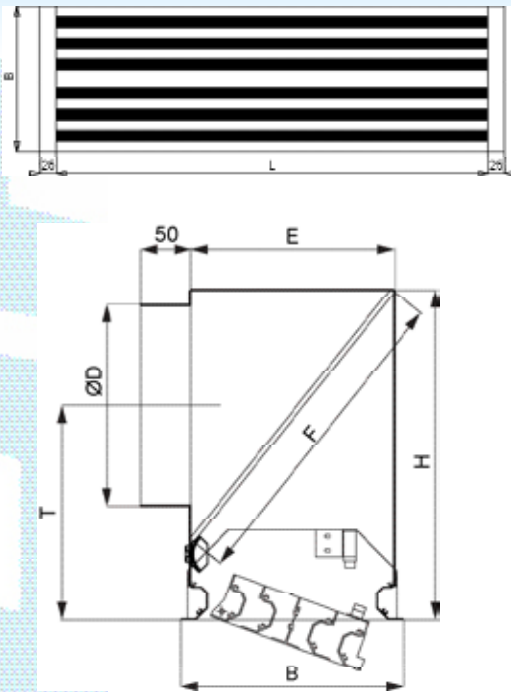

	4 SLOTS			
L	300	600	900	1200
B	157	157	157	157
Ø D	200	250	250	250
T	253	228	228	228
E (1R)	132	132	132	132
E (2R)	137	137	137	137
H	330	330	330	330
P	144	144	144	144
F (1R)	314	314	314	314
F (2R)	316	316	316	316

	5 SLOTS				6 SLOTS			
L	300	600	900	1200	300	600	900	1200
B	189	189	189	189	221	221	221	221
Ø D	200	250	250	250	200	250	250	250
T	253	228	228	228	253	228	228	228
E (1R)	164	164	164	164	196	196	196	196
E (2R)	169	169	169	169	201	201	201	201
H	330	330	330	330	330	330	330	330
P	176	176	176	176	208	208	208	208
F (1R)	328	328	328	328	345	345	345	345
F (2R)	331	331	331	331	348	348	348	348

	7 SLOTS				8 SLOTS			
L	300	600	900	1200	300	600	900	1200
B	253	253	253	253	285	285	285	285
Ø D	200	250	250	250	200	250	250	250
T	253	228	228	228	253	228	228	228
E (1R)	228	228	228	228	260	260	260	260
E (2R)	233	233	233	233	265	265	265	265
H	330	330	330	330	330	330	330	330
P	240	240	240	240	272	272	272	272
F (1R)	364	364	364	364	385	385	385	385
F (2R)	367	367	367	367	388	388	388	388

1R = 1 supply direction
2R = 2 supply directions

P = minimum ceiling opening width
nominal dimension = length of the filter
L + 13 = minimum ceiling opening length

Specifications description

Example:

Aluminium slot diffuser with 2 fixed supply slots in the same direction. Delivered complete with plenum box both with circular side entry spigot and damper. The diffuser is painted white (RAL 9010). The plenum is made out of galvanised steel sheet.

Type: TE602 + TP202 G
length ... mm

Delivery possibilities

1 SUPPLY DIRECTION

TE601/610



TE602/620



TE603/630

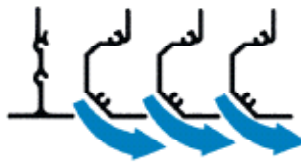

TE604/640/704/740



2 SUPPLY DIRECTIONS

TE611



TE612/621

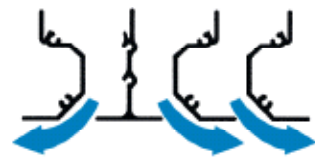

TE613/631/713/731



TE622/722

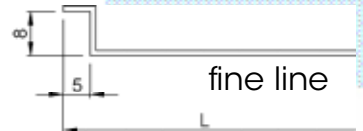

How to order

TE600 with 1 slot, supply direction at the right, air entry at the right, L = 900 mm.

T	E	6	0	1	P	F	S	G	D	0	1	0	0	1	2	5	0
---	---	---	---	---	---	---	---	---	---	---	---	---	---	---	---	---	---

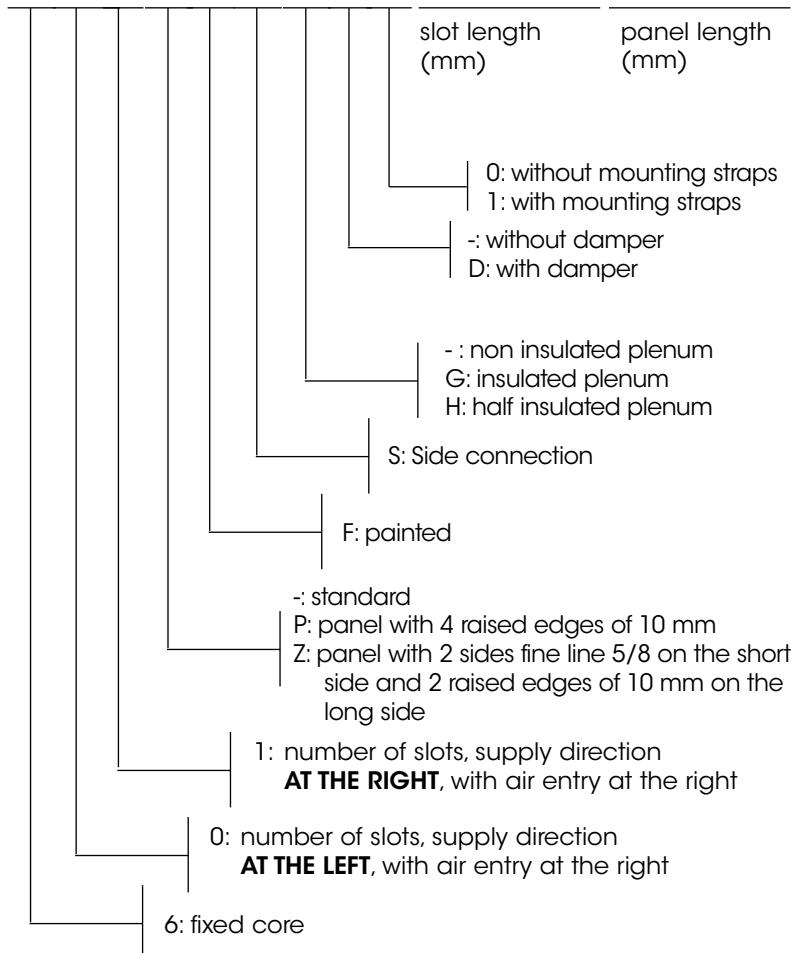

Note:

- Not available as a linear grille
- TE700 only available from 4 slots
- Anodised execution only available upon request

T	E	6	0	1	P	F	1	2	0	0	1	2	5	5
---	---	---	---	---	---	---	---	---	---	---	---	---	---	---

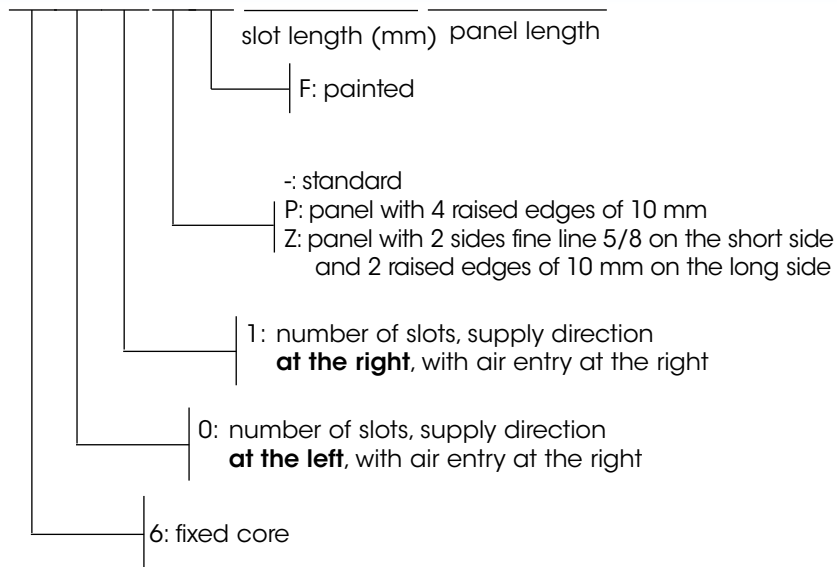

Slot diffuser in a panel

T	E	7	0	4	P	F	S	G	D	0	1	0	0	0	1	2	5	0
---	---	---	---	---	---	---	---	---	---	---	---	---	---	---	---	---	---	---

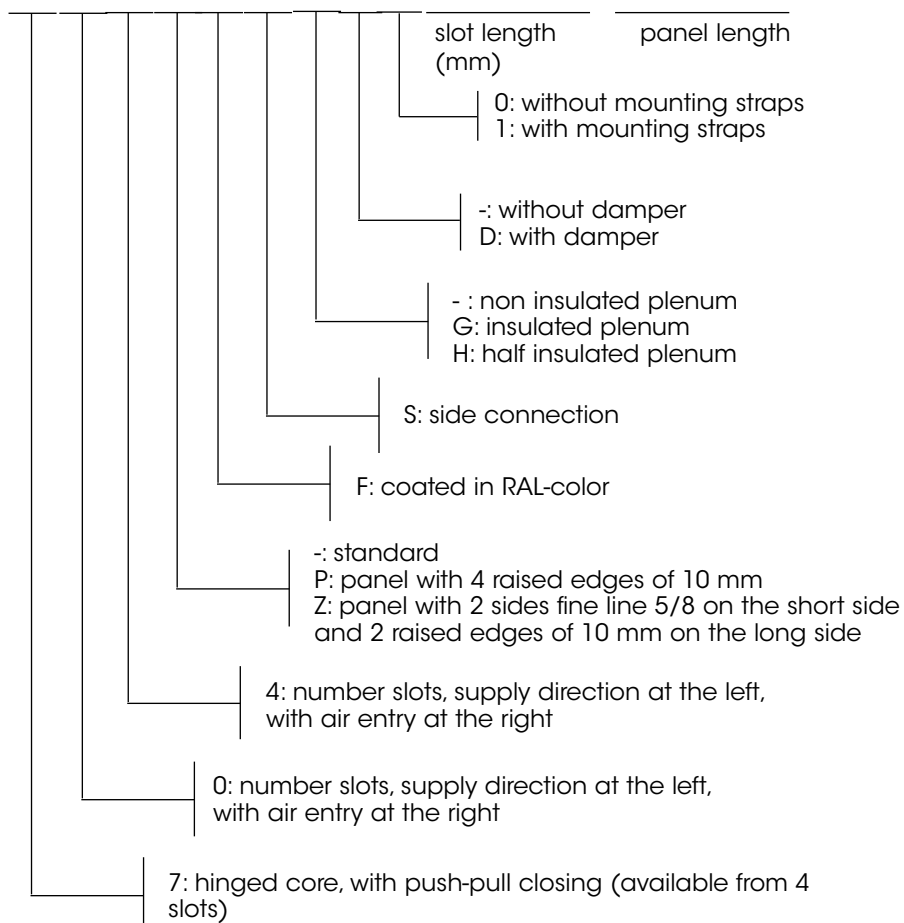

Slot diffuser in a panel

T	E	7	0	4	P	F	1	2	0	0	1	2	5	0
---	---	---	---	---	---	---	---	---	---	---	---	---	---	---

slot length (mm) panel length

F: coated in RAL-color

-: standard

P: panel with 4 raised edges of 10 mm

Z: panel with 2 sides fine line 5/8 on the short side and 2 raised edges of 10 mm on the long side

4: number slots, supply direction at the left, with air entry at the right

0: number slots, supply direction at the left, with air entry at the right

7: hinged core, with push-pull closing (available from 4 slots)

Note: The length of the panel must be 55 mm (at the minimum) longer than the nominal length of the diffuser.

PLENUM FOR FIXED SLOT DIFFUSER TP100 • TP700

Installation dimensions

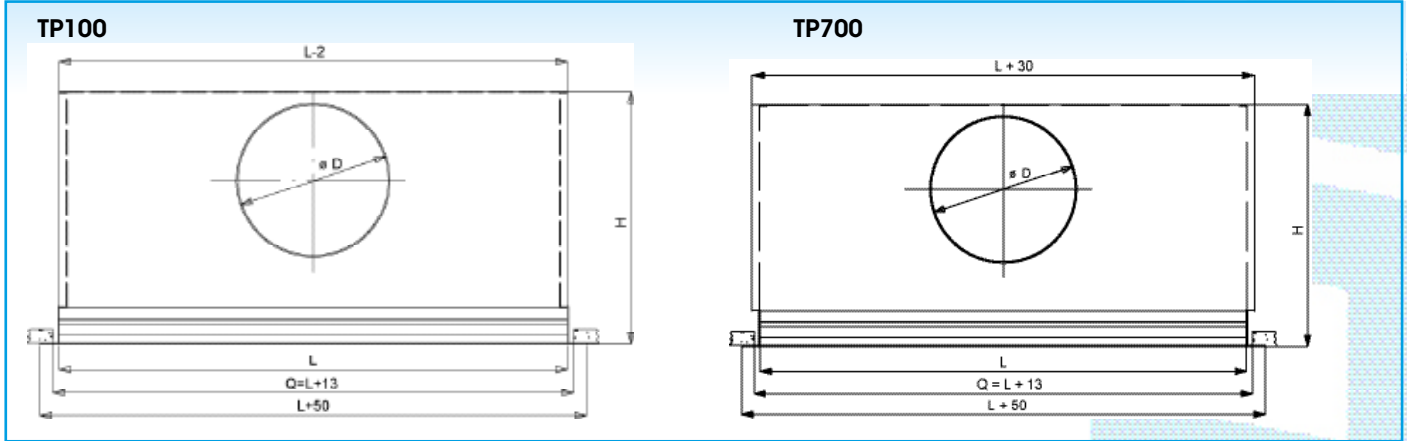

H = 325 mm (if TE600 is mounted with TP100)

H = 365 mm (if TE700 is mounted with TP700)

	1 SLOT				2 SLOTS				3 SLOTS			
L	300	600	900	1200	300	600	900	1200	300	600	900	1200
∅ D	125	125	160	200	125	160	200	250	160	200	250	250
	4 SLOTS				5 SLOTS				6 SLOTS			
L	300	600	900	1200	300	600	900	1200	300	600	900	1200
∅ D	200	250	250	250	200	250	250	250	200	250	250	250
	7 SLOTS				8 SLOTS							
L	300	600	900	1200	300	600	900	1200				
∅ D	200	250	250	250	200	250	250	250				

How to order

TP100, not insulated and without damper for TE601, L = 900 mm.

T	P	1	0	1	-	-	0	1	2	5	0	9	0	0
---	---	---	---	---	---	---	---	---	---	---	---	---	---	---

- spigot diameter Slot length (mm)
- : non insulated plenum
- G: internally insulated plenum
- H: double sided insulated plenum
- 1: number of slots, supply direction
AT THE RIGHT, with air entry at the right
- 0: number of slots, supply direction
AT THE LEFT, with air entry at the right
- 1: without damper in inlet spigot (for TE600)
- 2: with damper in inlet spigot (for TE600)
- 3: without damper in inlet spigot, provided with mounting straps (for TE600)
- 4: with damper in inlet spigot, provided with mounting straps (for TE600)
- 7: bevelled filterframe without damper in inlet spigot (for TE700)
- 8: bevelled filterframe with damper in inlet spigot (for TE700)
- 9: bevelled filterframe without damper in inlet spigot, provided with mounting straps (for TE700)